

SERIES T

Model T-2



DATA SHEET

NET WEIGHT **92kg (203lbs)**
 SHIPPING WEIGHTS **114kg (252lbs)**
 IMPELLER DIA. **158,75mm (6.1/4")**
 R.P.M. FROM **1150rpm TO 2900rpm**
 MAX. SOLIDS **44,45mm (1.3/4")**

SELF-PRIMING

1150 RPM 7,3m (24ft) - 1450 RPM 7,6m (25ft)
 1750 RPM 7,6m (25ft) - 2050 RPM 7,6m (25ft)
 2350 RPM 7,6m (25ft) - 2650 RPM 7,6m (25ft)
 2650 RPM 7,6m (25ft) - 2900 RPM 7,6m (25ft)

BEFORE USING THIS TABLE, CHECK THE NPSH.

PERFORMANCE CURVE 2"x2"

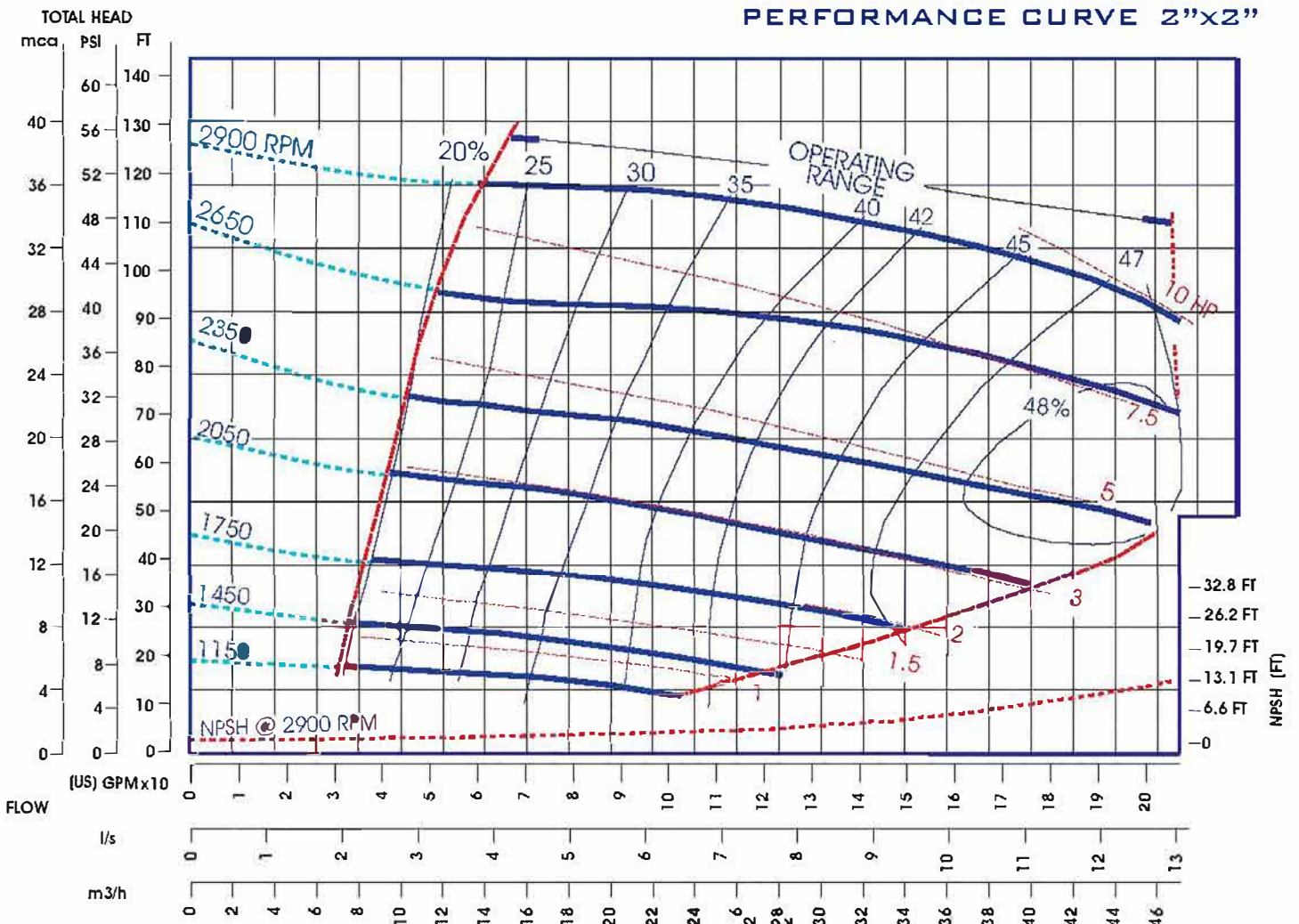

EXTERNAL DIMENSIONS
MILLIMETERS (INCHES)

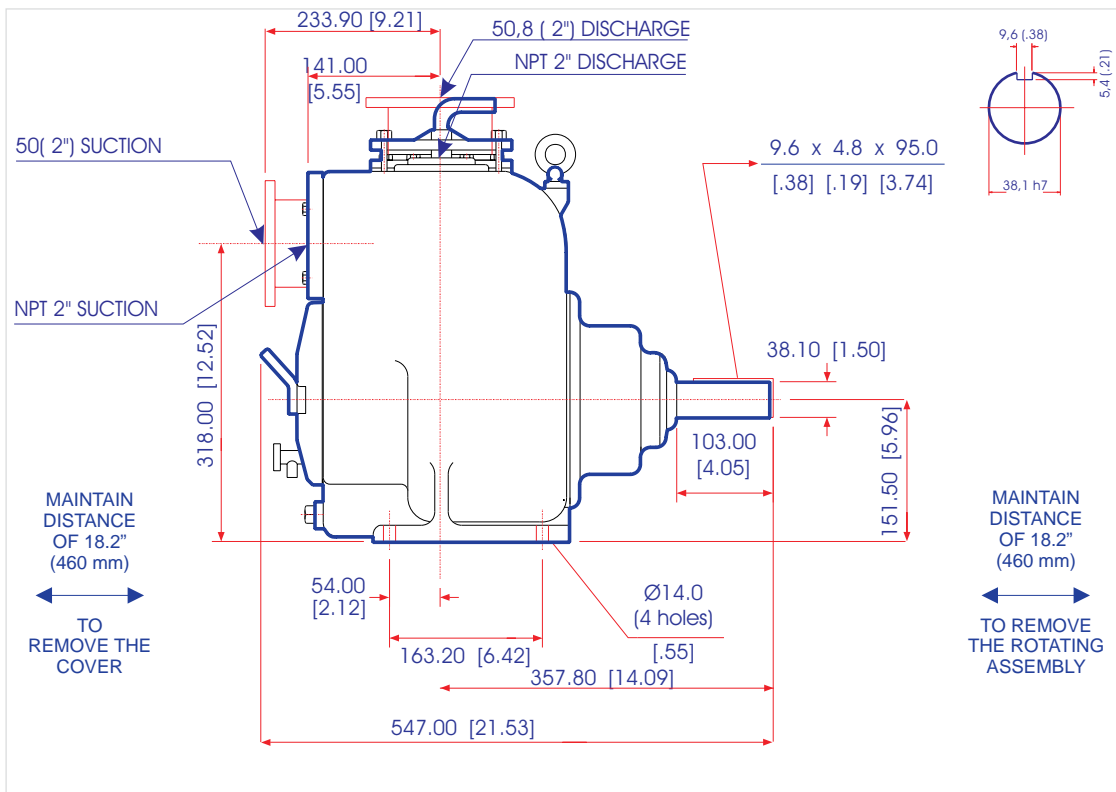
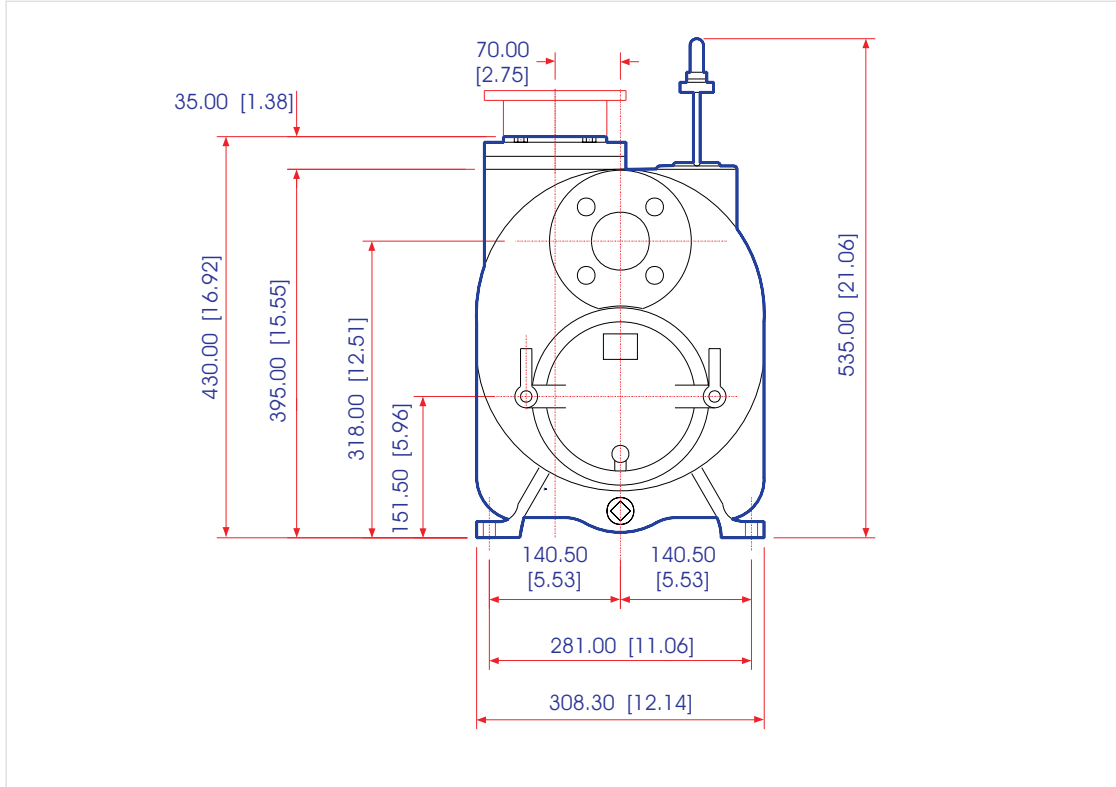

Series T

Model T-3



DATA SHEET

NET WEIGHT 183kg (404lbs)
SHIPPING WEIGHTS 205kg (452lbs)
IMPELLER DIA. 222,25mm (8.3/4")
R.P.M. FROM 650rpm TO 2150rpm
MAX. SOLIDS 63,5mm (2.1/2")

SELF-PRIMING

650 RPM 1,5m (5ft) - 750 RPM 1,8m (6ft)
 850 RPM 2,4m (8ft) - 950 RPM 3,0m (10ft)
 1050 RPM 4,0m (13ft) - 1150 RPM 4,9m (16ft)
 1250 RPM 5,5m (18ft) - 1350 RPM 5,8m (19ft)
 1450 RPM 6,4m (21ft) - 1550 RPM 6,4m (21ft)
 1650 RPM 6,7m (22ft) - 1750 RPM 6,7m (22ft)
 1850 RPM 7,6m (25ft) - 1950 RPM 7,6m (25ft)
 2050 RPM 7,6m (25ft) - 2150 RPM 7,6m (25ft)

BEFORE USING THIS TABLE, CHECK THE NPSH.

PERFORMANCE CURVE 3"x3"

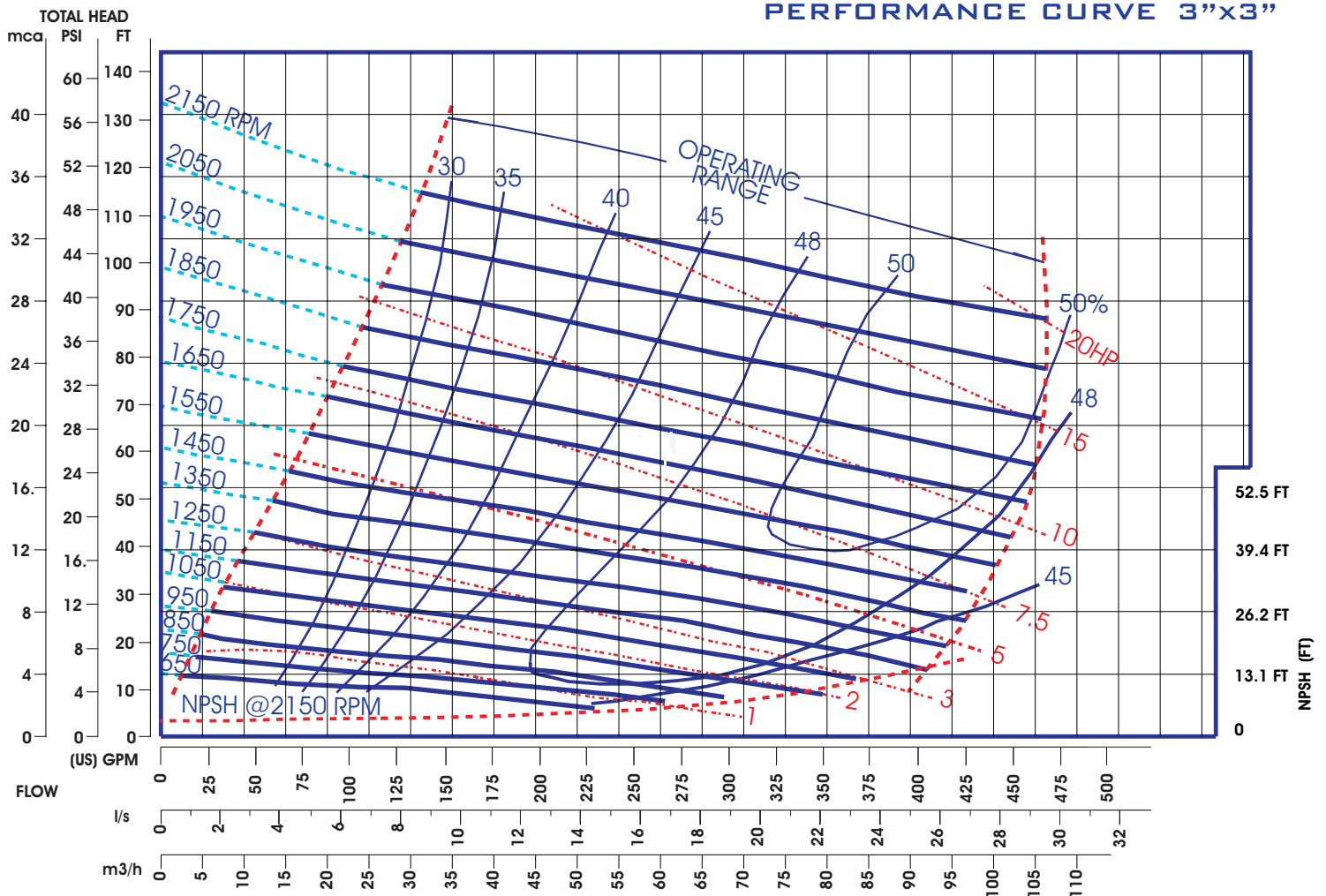

Series T

Model T-3

EXTERNAL DIMENSIONS MILLIMETERS (INCHES)

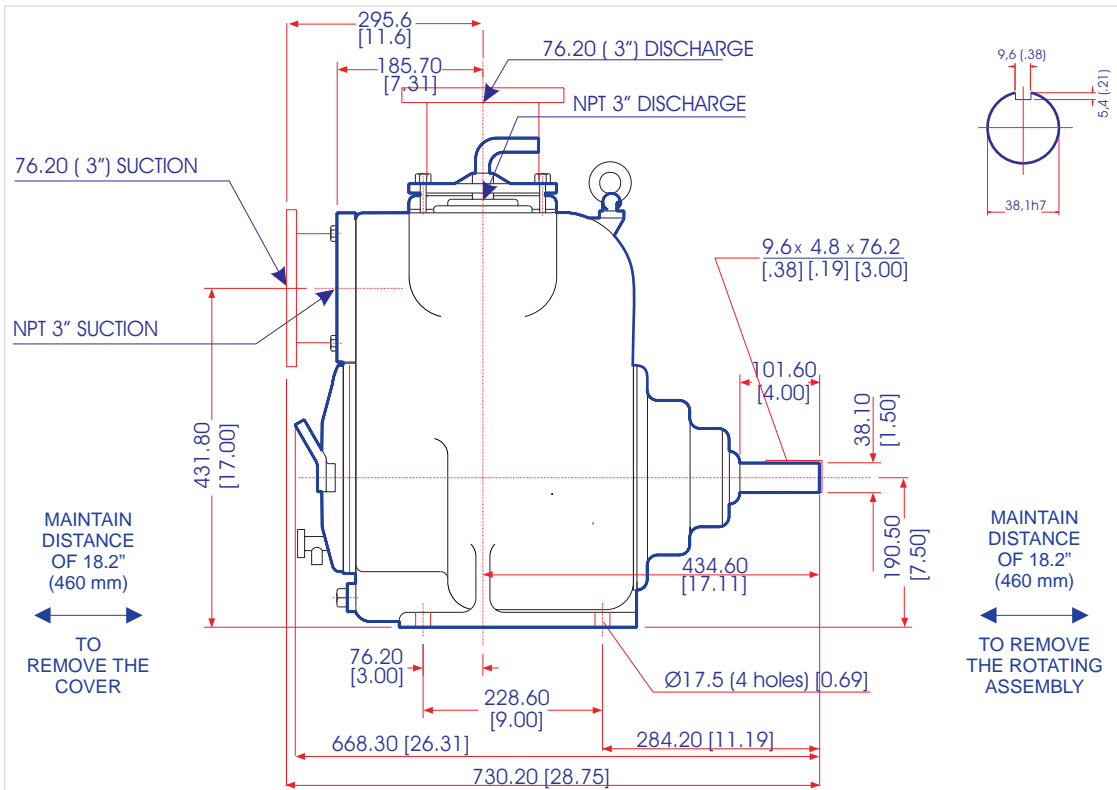
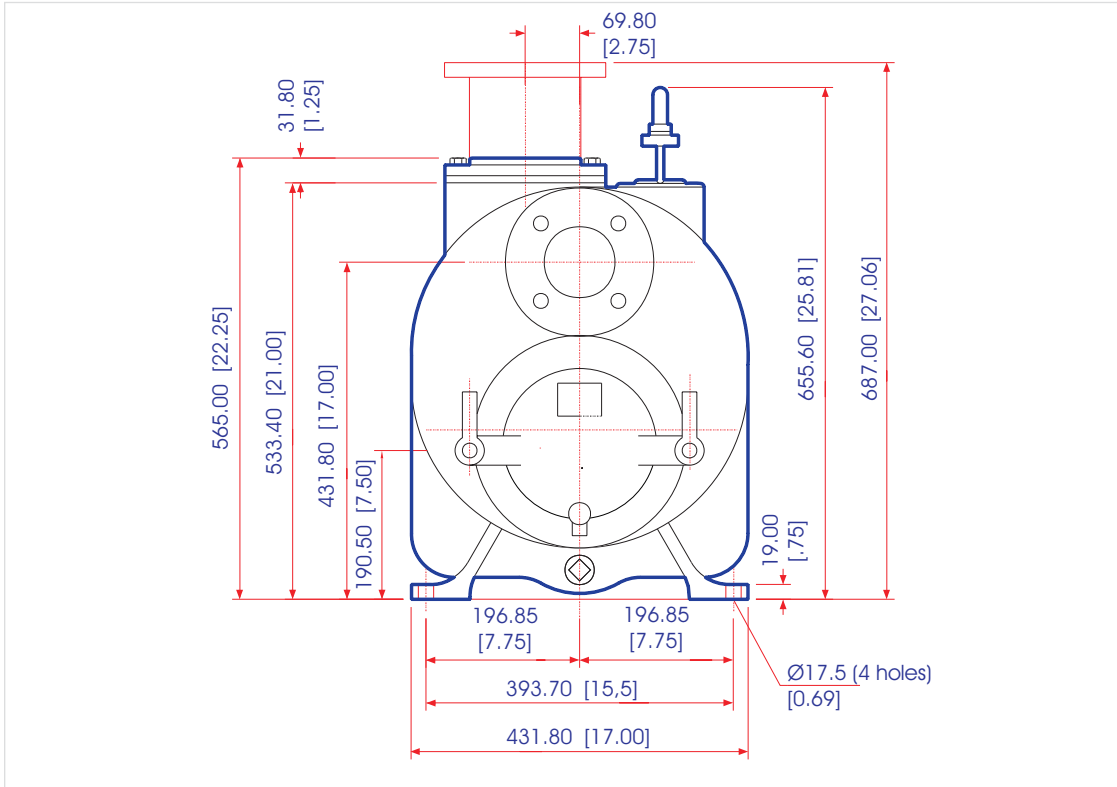

Series T

Model T-4



DATA SHEET

NET WEIGHT 259,5kg (600lbs)
SHIPPING WEIGHTS 280kg (655lbs)
IMPELLER DIA. 247,65mm (9.3/4")
R.P.M. FROM 650rpm TO 1950rpm
MAX. SOLIDS 76,2mm (3")

SELF-PRIMING

650 RPM 1,5m (5ft) - 750 RPM 2,4m (8ft)
 850 RPM 4,9m (16ft) - 950 RPM 5,8m (19ft)
 1050 RPM 6,7m (22ft) - 1150 RPM 7,3m (24ft)
 1250 RPM 7,6m (25ft) - 1350 RPM 7,6m (25ft)
 1450 RPM 7,6m (25ft) - 1550 RPM 7,6m (25ft)
 1650 RPM 7,6m (25ft) - 1750 RPM 7,6m (25ft)
 1850 RPM 7,6m (25ft) - 1950 RPM 7,6m (25ft)

BEFORE USING THIS TABLE, CHECK THE NPSH.

PERFORMANCE CURVE 4"x4"

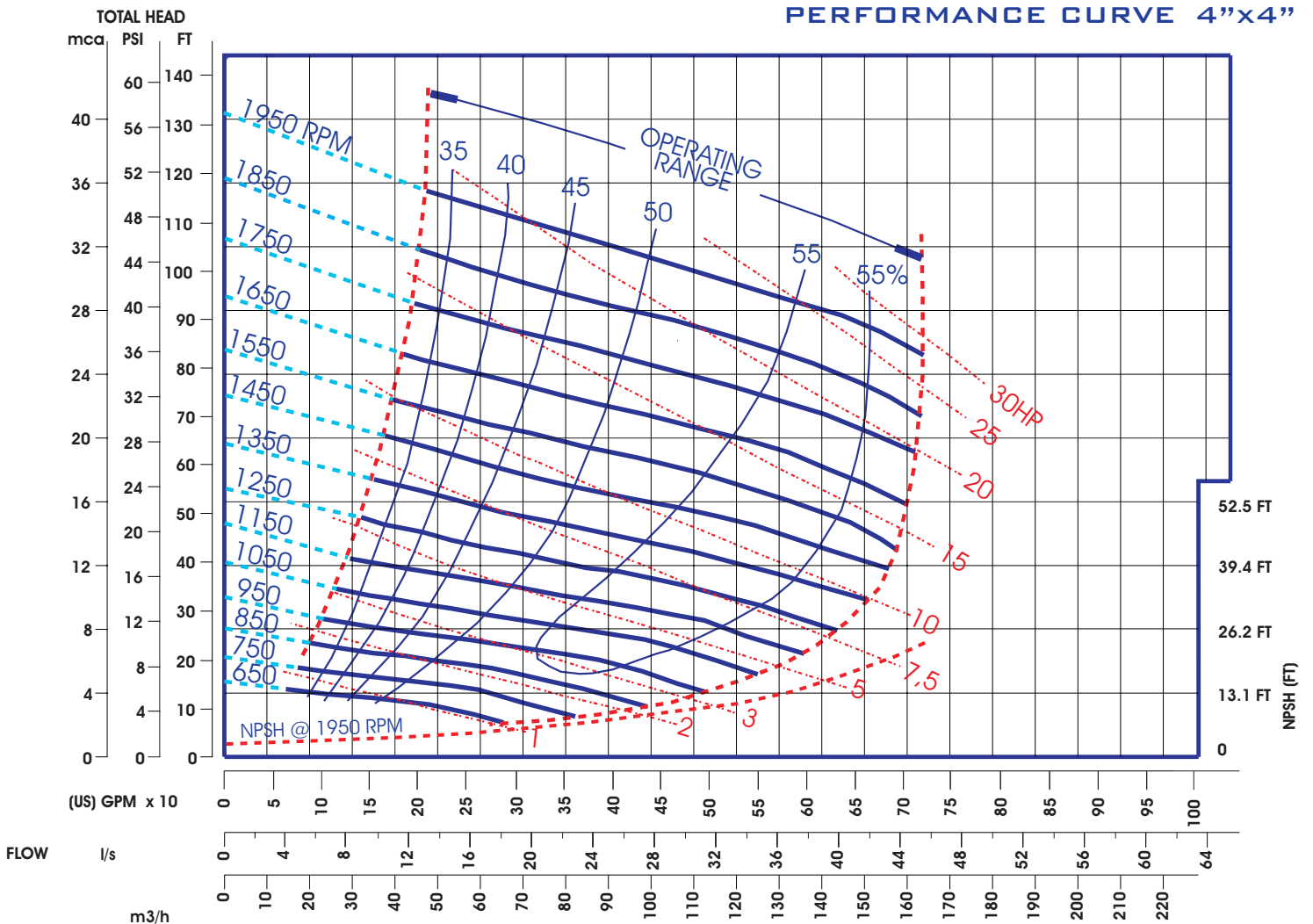

EXTERNAL DIMENSIONS
MILLIMETERS (INCHES)

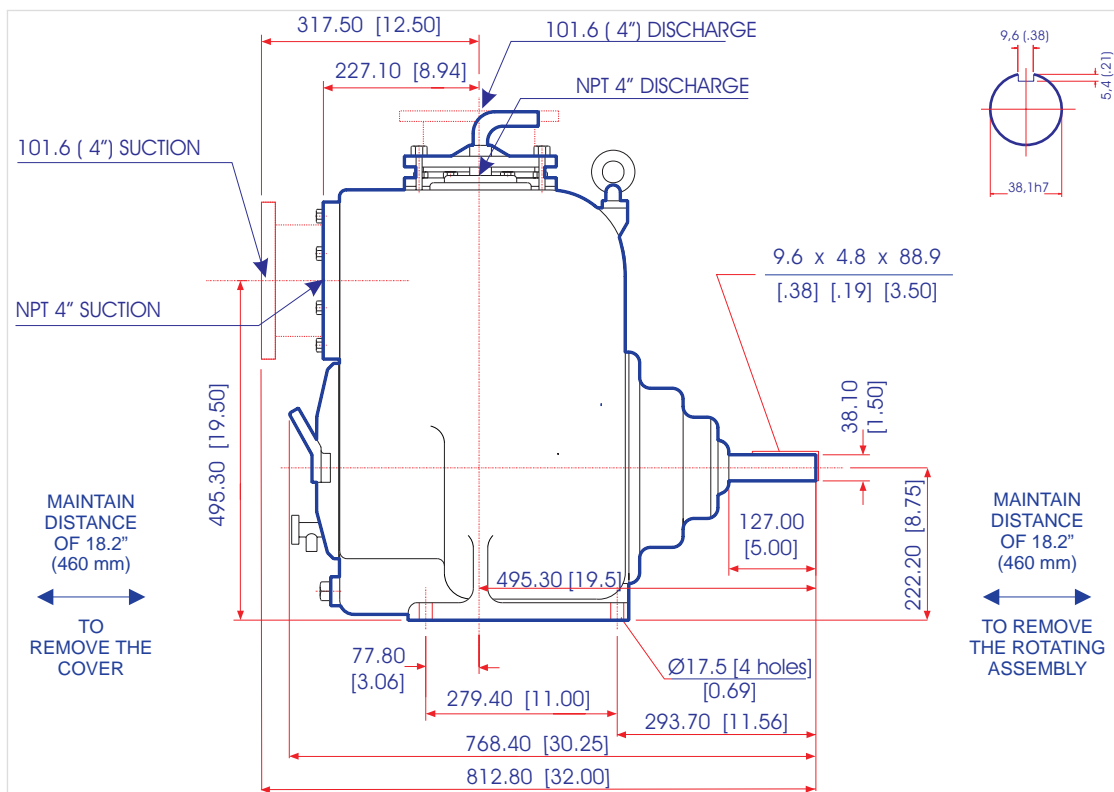
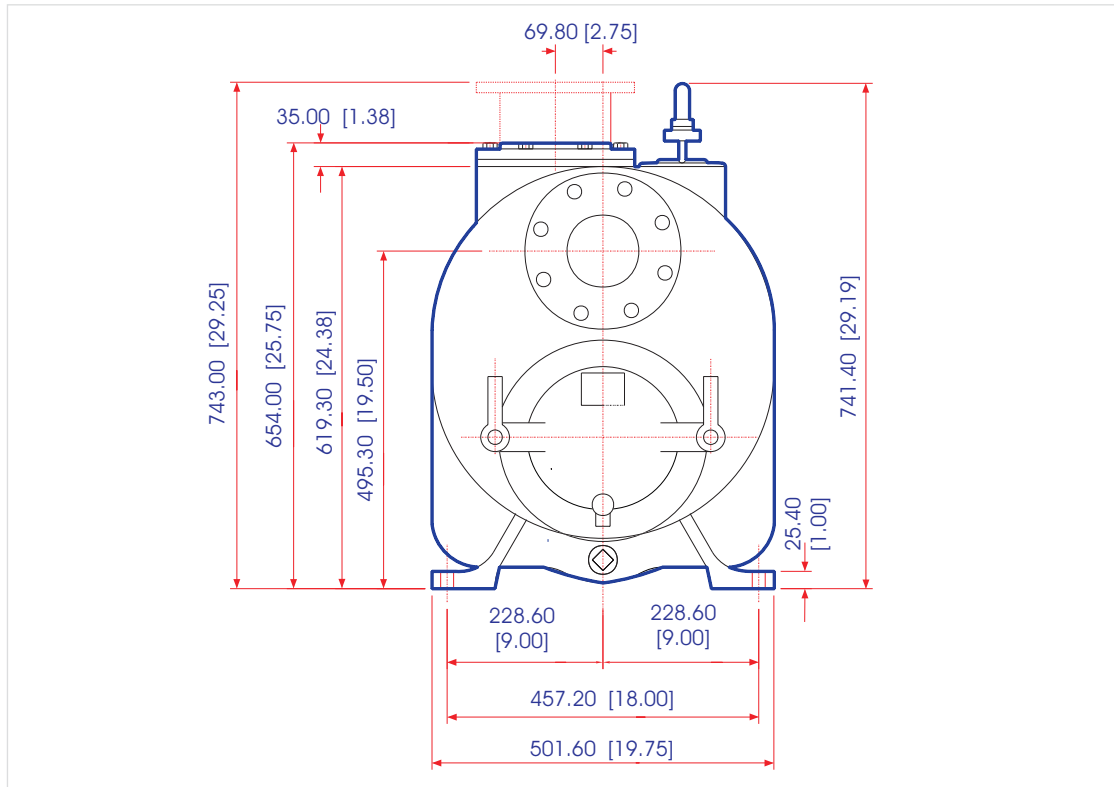

Series T

Model T-6



DATA SHEET

NET WEIGHT 364kg (802lbs)
SHIPPING WEIGHTS 391kg (862lbs)
IMPELLER DIA. 314,32mm (12.3/8")
R.P.M. FROM 650rpm TO 1550rpm
MAX. SOLIDS 76,2mm (3")

SELF-PRIMING

650 RPM 2,4m (8ft) - 750 RPM 2,7m (9ft)
 850 RPM 3,6m (12ft) - 950 RPM 4,2m (14ft)
 1050 RPM 5,5m (18ft) - 1150 RPM 6,4m (21ft)
 1250 RPM 6,4m (21ft) - 1350 RPM 6,7m (22ft)
 1450 RPM 7,0m (23ft) - 1550 RPM 7,6m (25ft)

BEFORE USING THIS TABLE, CHECK THE NPSH.

PERFORMANCE CURVE 6"x6"

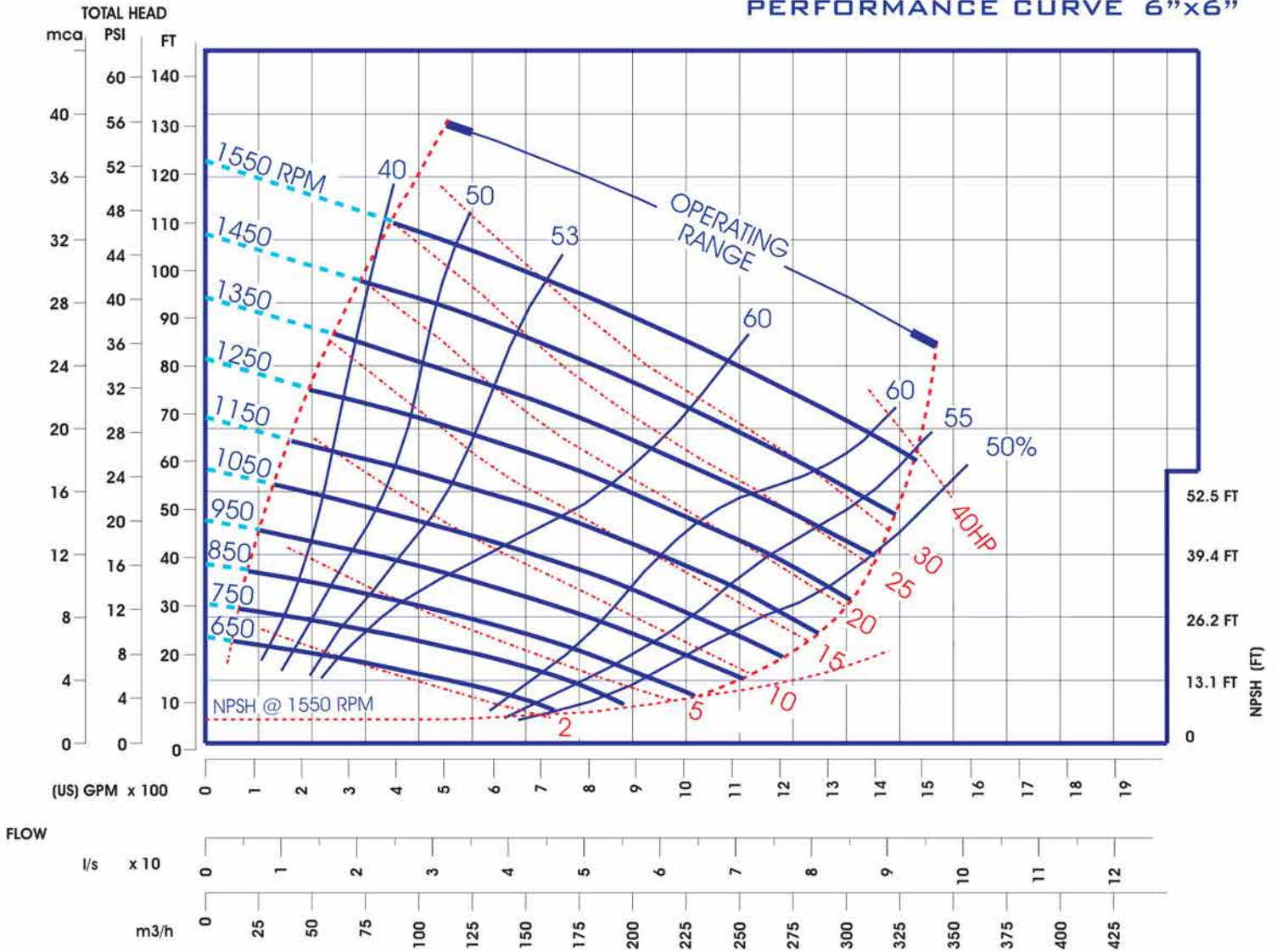

Series T

Model T-6

EXTERNAL DIMENSIONS MILLIMETERS (INCHES)

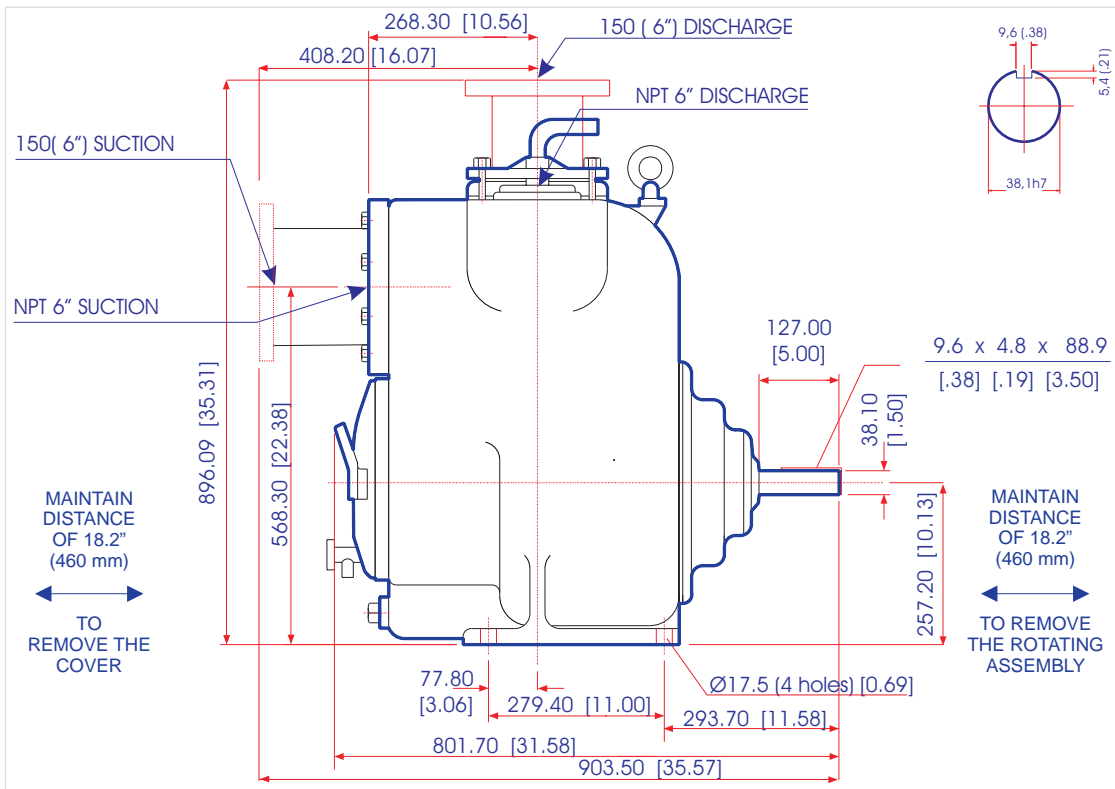
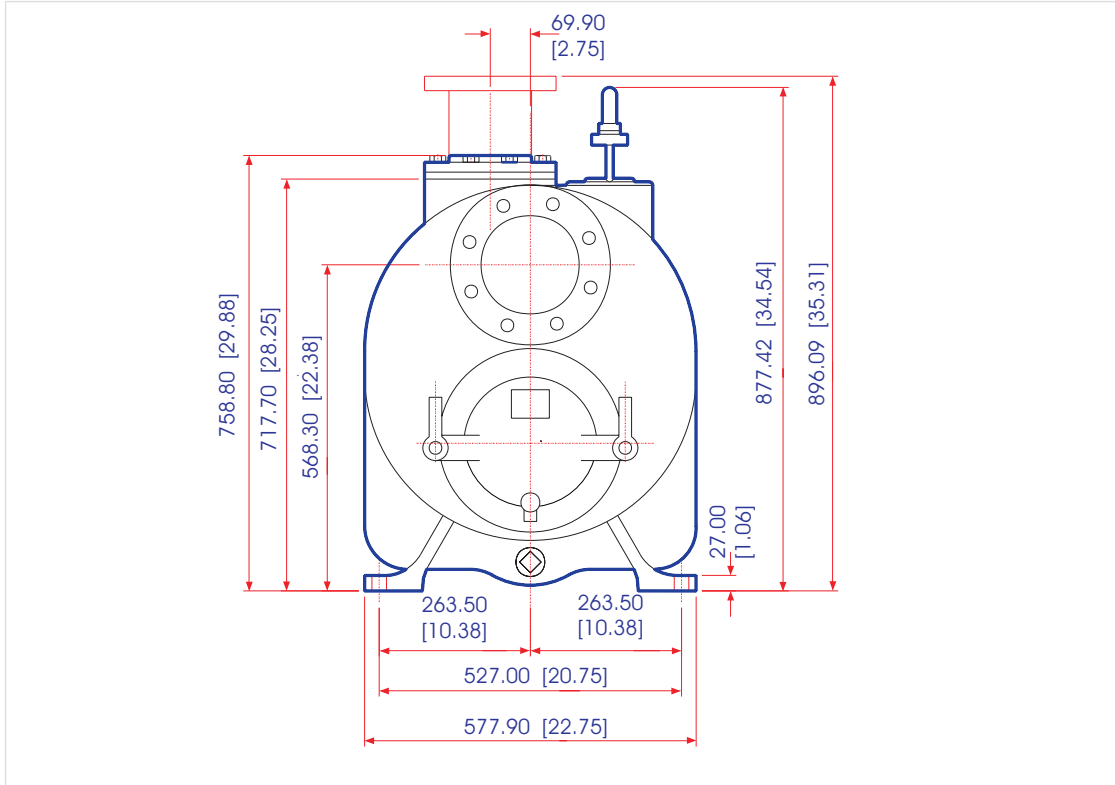

Series T

Model T-8



DATA SHEET

NET WEIGHT 581 kg (1295 lbs)
SHIPPING WEIGHTS 634 kg (1399 lbs)
IMPELLER DIA. 374.65 mm (14.3/4")
R.P.M. FROM 650rpm TO 1350rpm
MAX. SOLIDS 76,2mm (3")

SELF-PRIMING

650 RPM 2,7m (9ft) - 750 RPM 3,7m (12ft)
 850 RPM 4,6m (15ft) - 950 RPM 5,2m (17ft)
 1050 RPM 6,1m (20ft) - 1150 RPM 6,4m (21ft)
 1250 RPM 6,7m (22ft) - 1350 RPM 7,0m (23ft)

BEFORE USING THIS TABLE, CHECK THE NPSH.

PERFORMANCE CURVE 8"x8"

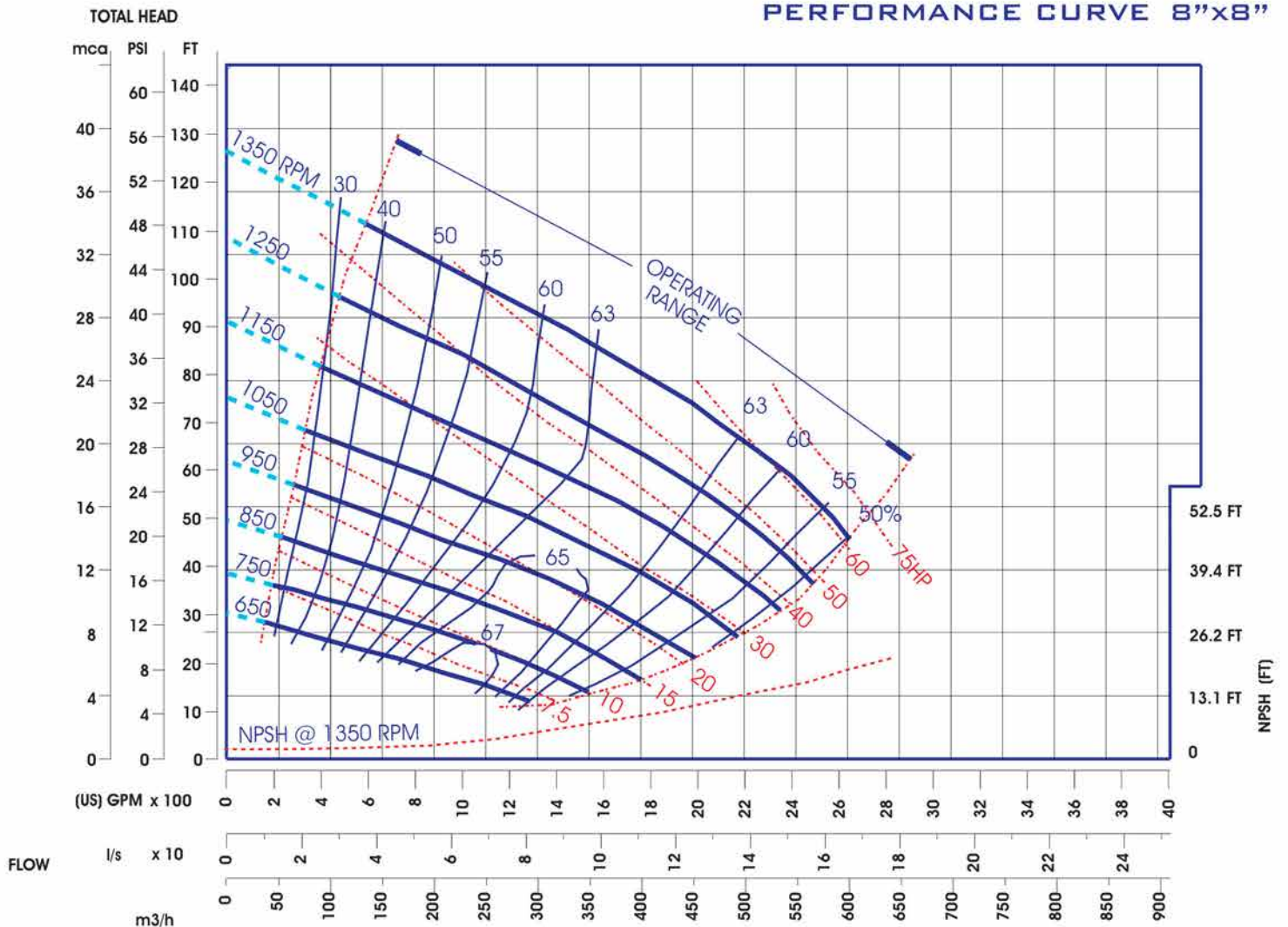

Series T

Model T-8

EXTERNAL DIMENSIONS MILLIMETERS (INCHES)

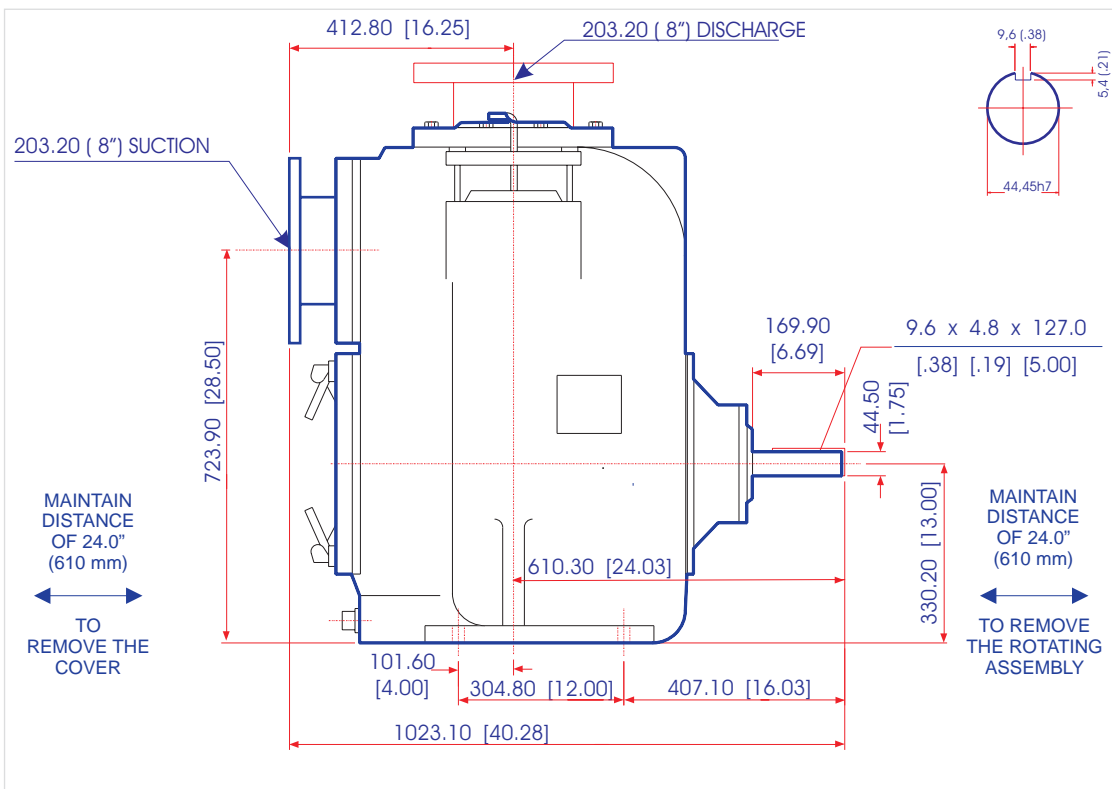
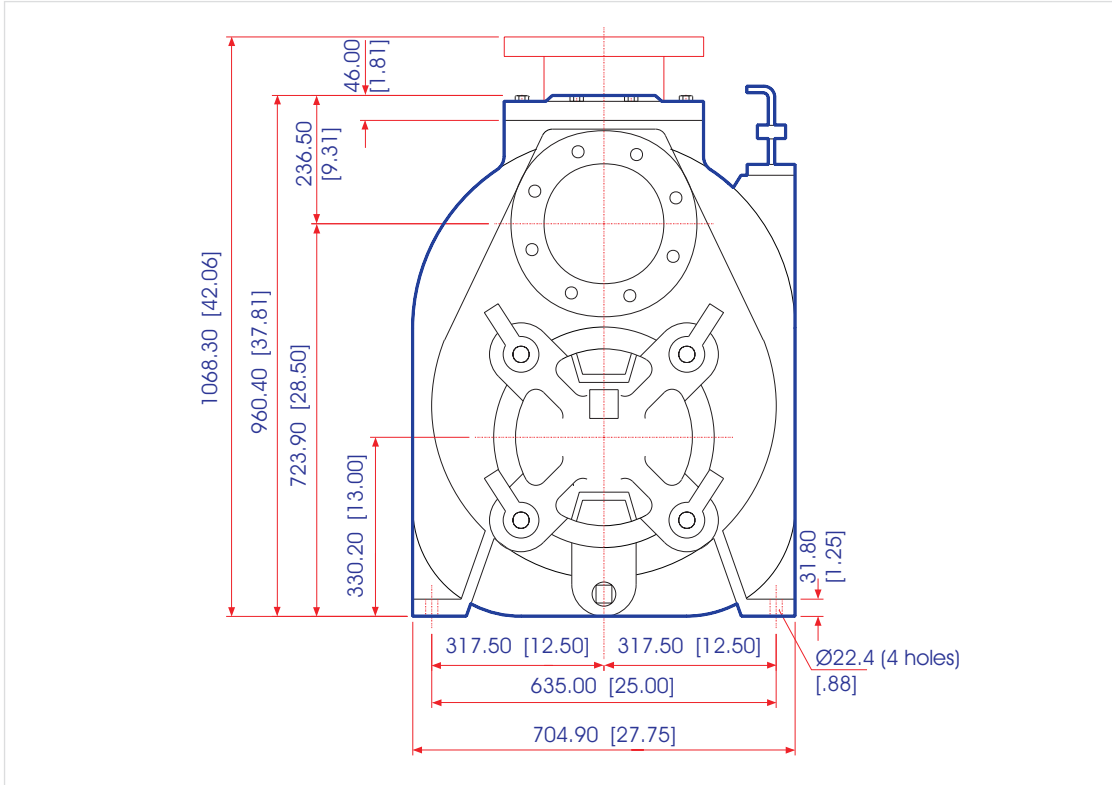

Series T

Model T-10

EXTERNAL DIMENSIONS MILLIMETERS (INCHES)

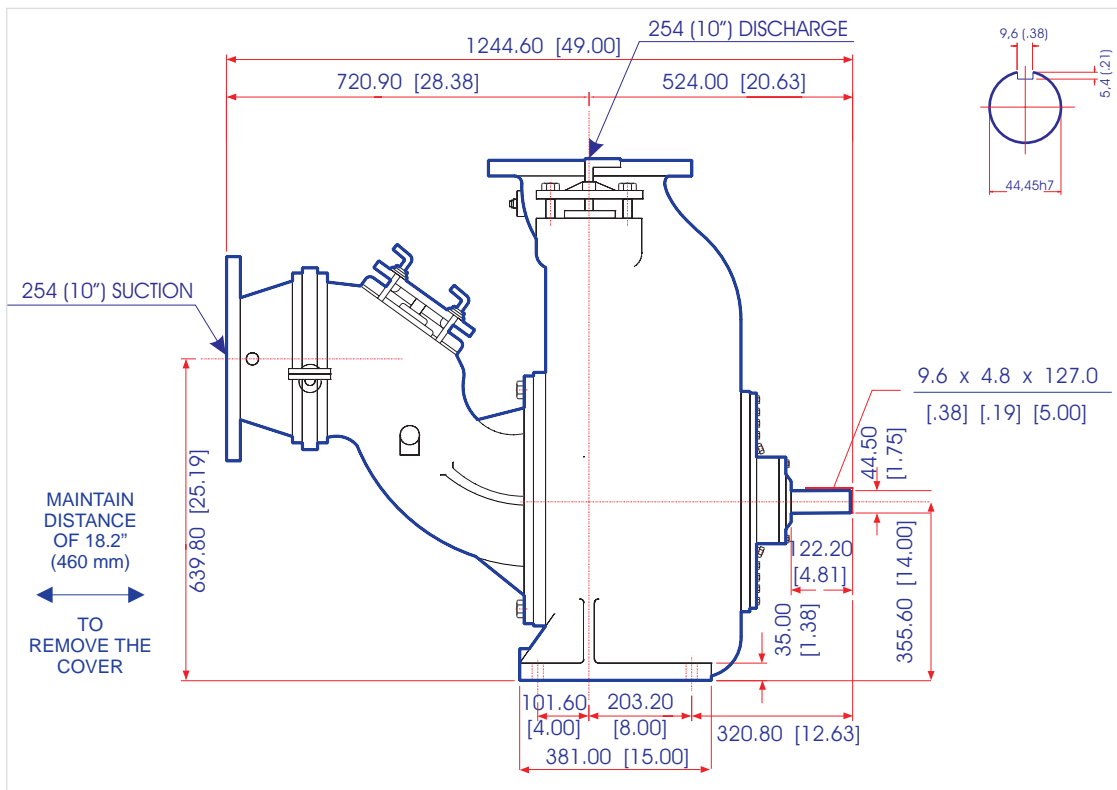
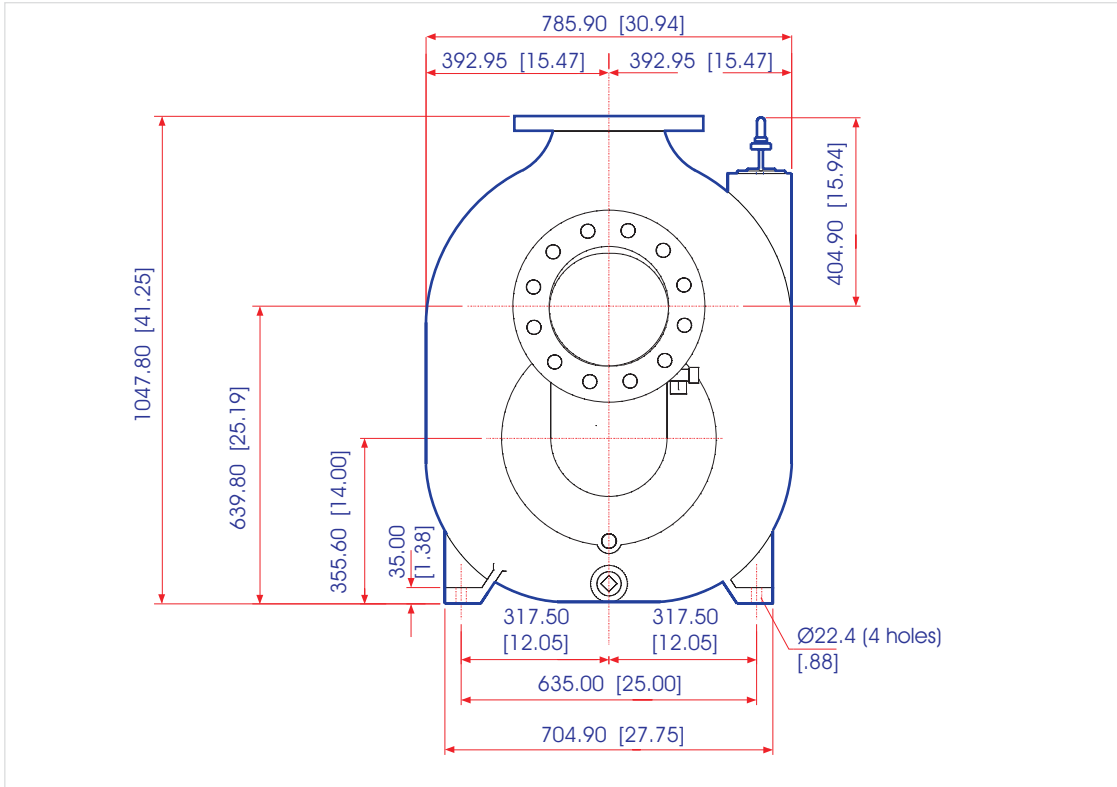

Series T

Model T-12



DATA SHEET

NET WEIGHT 998kg (2200lbs)
SHIPPING WEIGHTS 1066kg (2350lbs)
IMPELLER DIA. 457,2mm (18")
R.P.M. FROM 650rpm TO 1250rpm
MAX. SOLIDS 76,2mm (3")

SELF-PRIMING

650 RPM 1,6m (5ft) - 750 RPM 2,7m (9ft)
850 RPM 3,9m (13ft) - 950 RPM 4,5m (15ft)
1050 RPM 4,9m (16ft) - 1150 RPM 4,9m (16ft)
1250 RPM 4,9m (16ft)

BEFORE USING THIS TABLE, CHECK THE NPSH.

PERFORMANCE CURVE 12"x12"

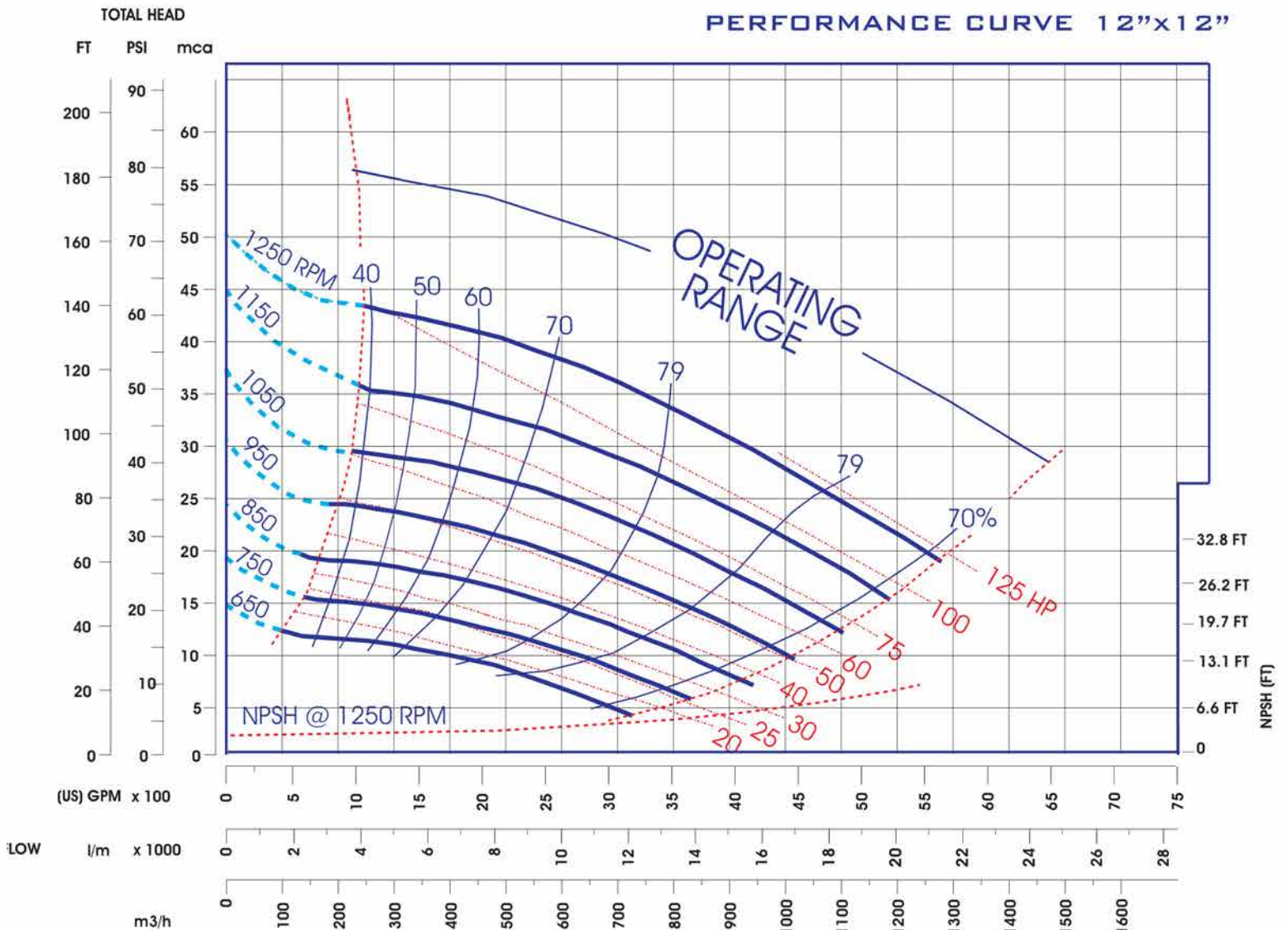

EXTERNAL DIMENSIONS MILLIMETERS (INCHES)

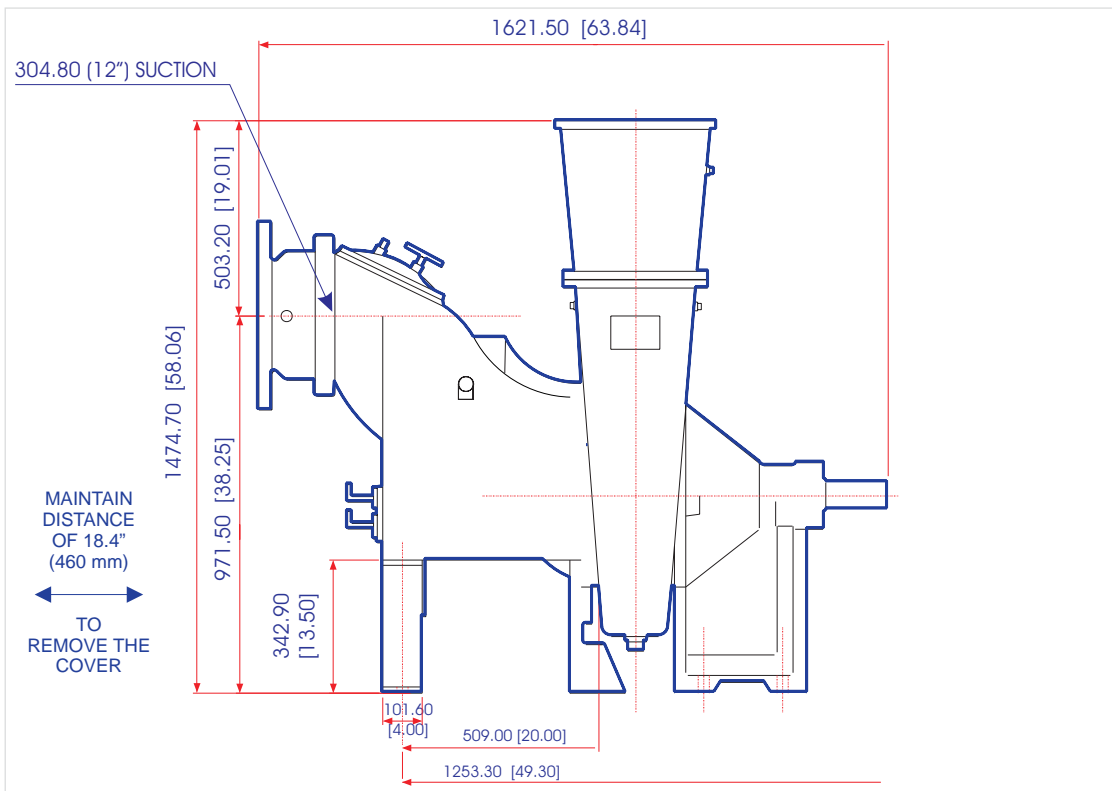
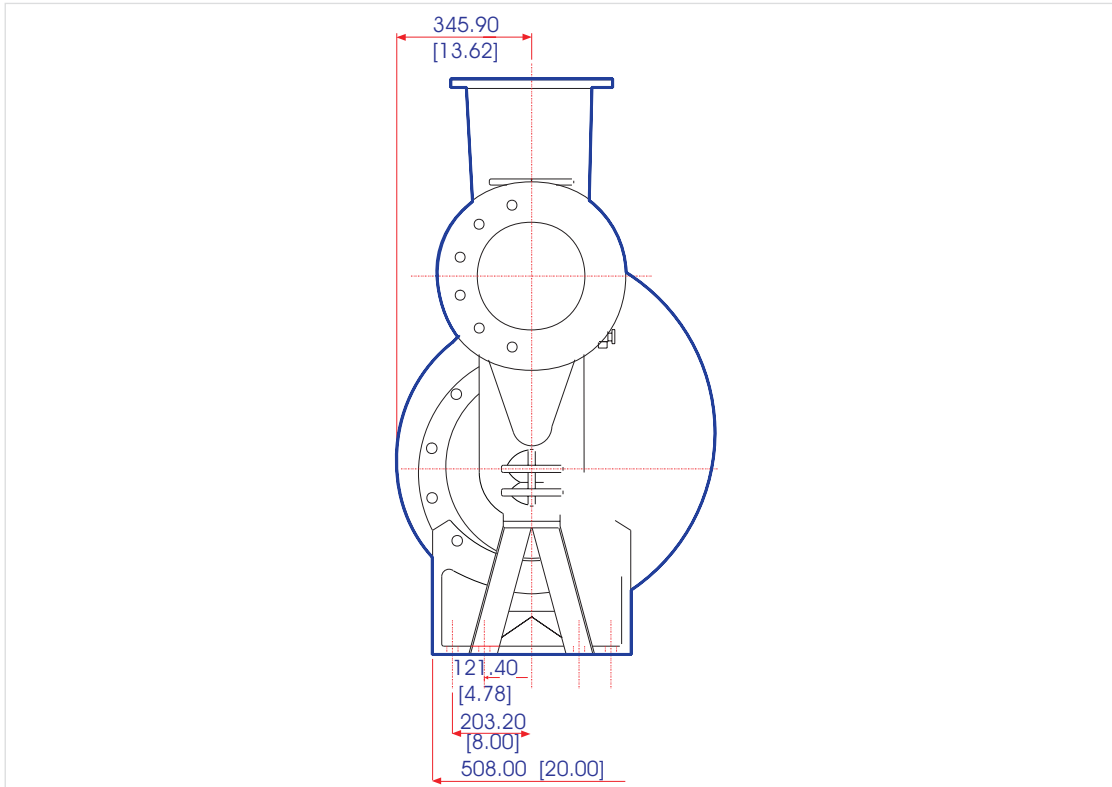

Series U

Model U-3



DATA SHEET

NET WEIGHT 214kg (472lbs)
SHIPPING WEIGHTS 225kg (497lbs)
IMPELLER DIA. 279,4mm (11")
R.P.M. FROM 850rpm TO 2150rpm
MAX. SOLIDS 20.63mm (13/16")

SELF-PRIMING

850 RPM 2,3m (7ft) - 1150 RPM 2,9m (9ft)
 1450 RPM 4,5m (15ft) - 1750 RPM 7,6m (25ft)
 1950 RPM 7,6m (25ft) - 2150 RPM 7,6m (25ft)

BEFORE USING THIS TABLE, CHECK THE NPSH.

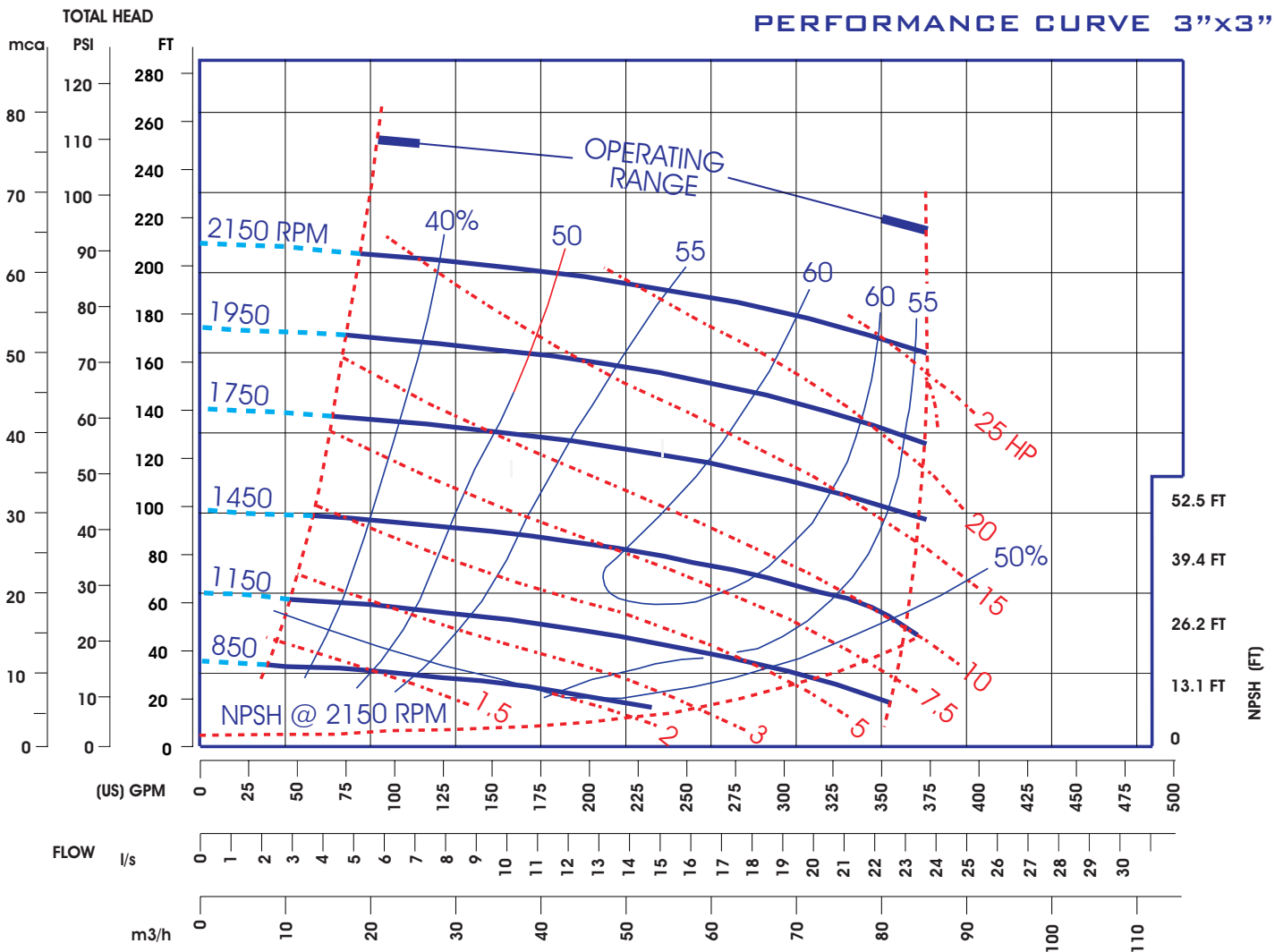

Series U

Model U-4



DATA SHEET

NET WEIGHT **272kg (600lbs)**
 SHIPPING WEIGHTS **297kg (655lbs)**
 IMPELLER DIA. **279,4mm (11")**
 R.P.M. **FROM 850rpm TO 2150rpm**
 MAX. SOLIDS **28.57mm (1.1/8")**

SELF-PRIMING

850 RPM 2,4m (8ft) - 1150 RPM 3,0m (10ft)
 1450 RPM 3,6m (12ft) - 1750 RPM 3,9m (13ft)
 1950 RPM 4,5m (15ft) - 2150 RPM 5,2m (17ft)

BEFORE USING THIS TABLE, CHECK THE NPSH.

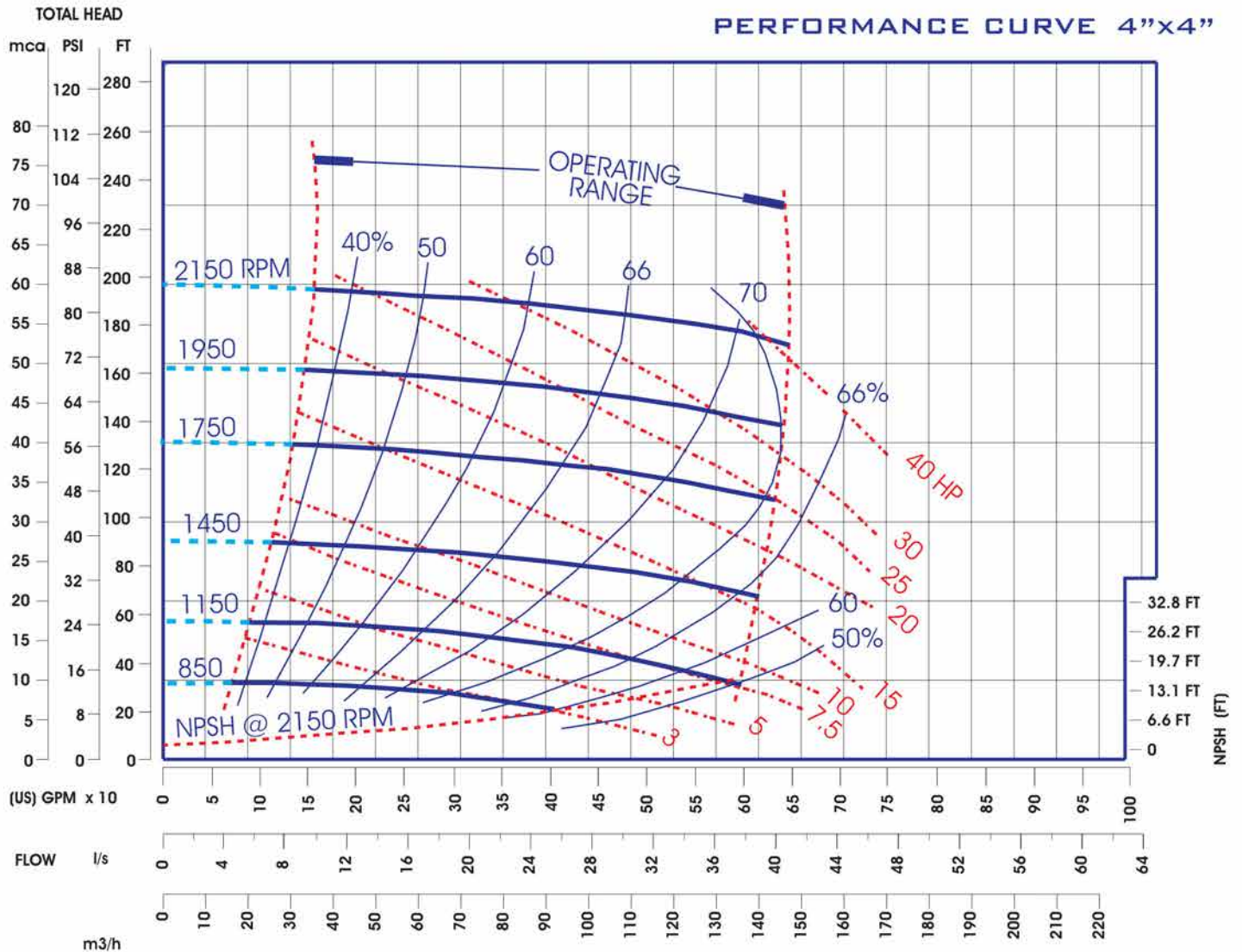

Series U

Model U-6



DATA SHEET

NET WEIGHT 413kg (910lbs)
SHIPPING WEIGHTS 437kg (965lbs)
IMPELLER DIA. 317,5mm (12.1/2")
R.P.M. FROM 850rpm TO 1950rpm
MAX. SOLIDS 31,75mm (1.1/4")

SELF-PRIMING

850 RPM 2,4m (8ft) - 1150 RPM 3,0m (10ft)
1450 RPM 4,2m (10ft) - 1750 RPM 4,5m (15ft)
1950 RPM 4,5m (15ft)

BEFORE USING THIS TABLE, CHECK THE NPSH.

PERFORMANCE CURVE 6"x6"

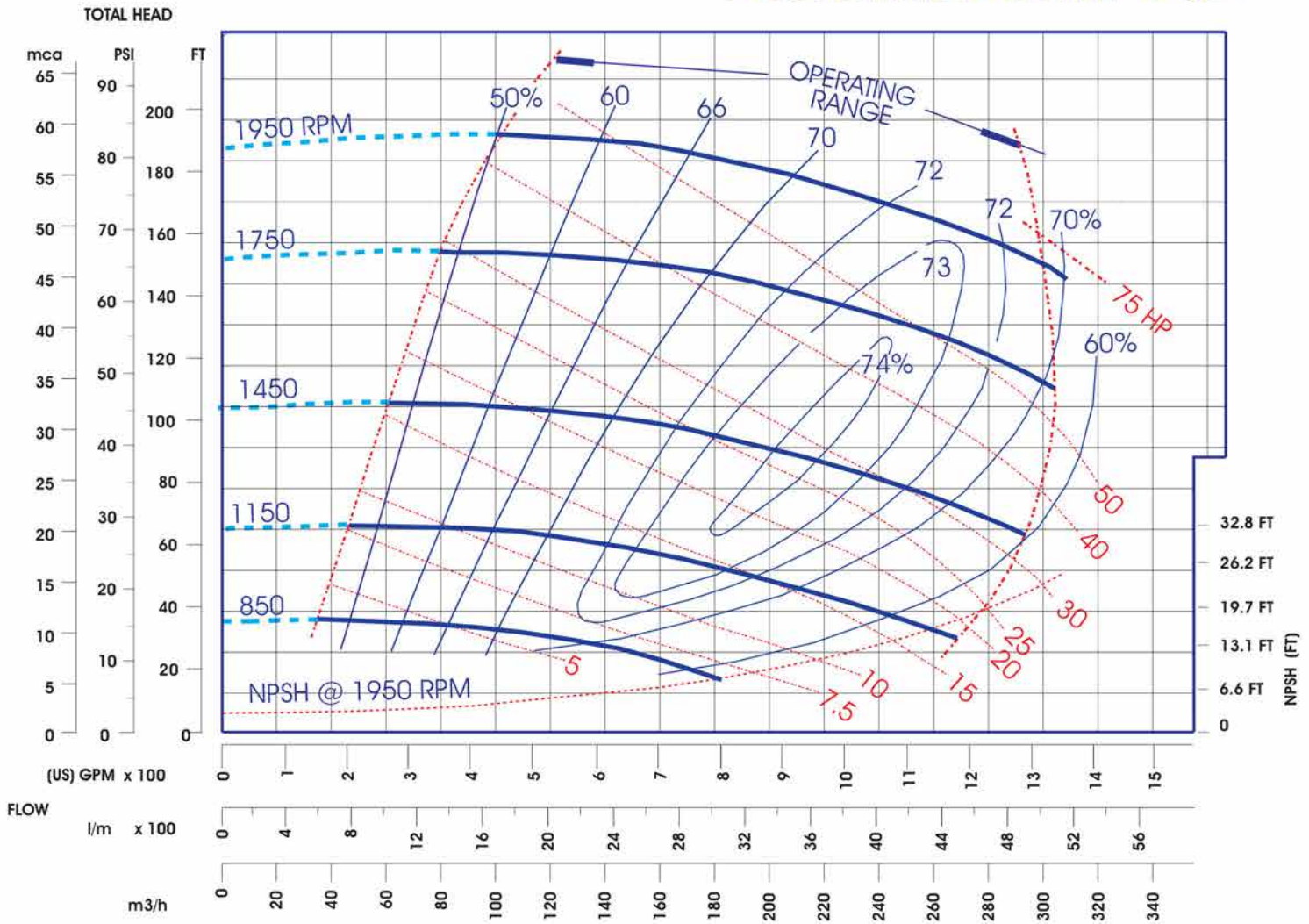

EXTERNAL DIMENSIONS
MILLIMETERS (INCHES)

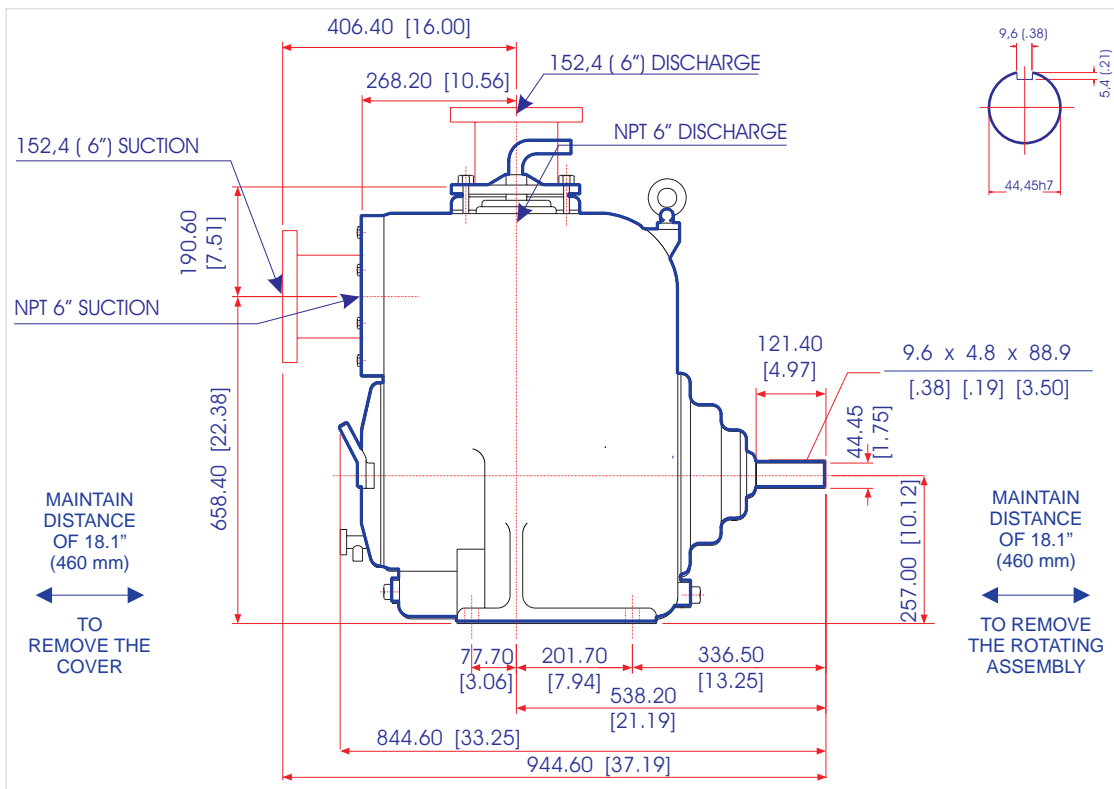
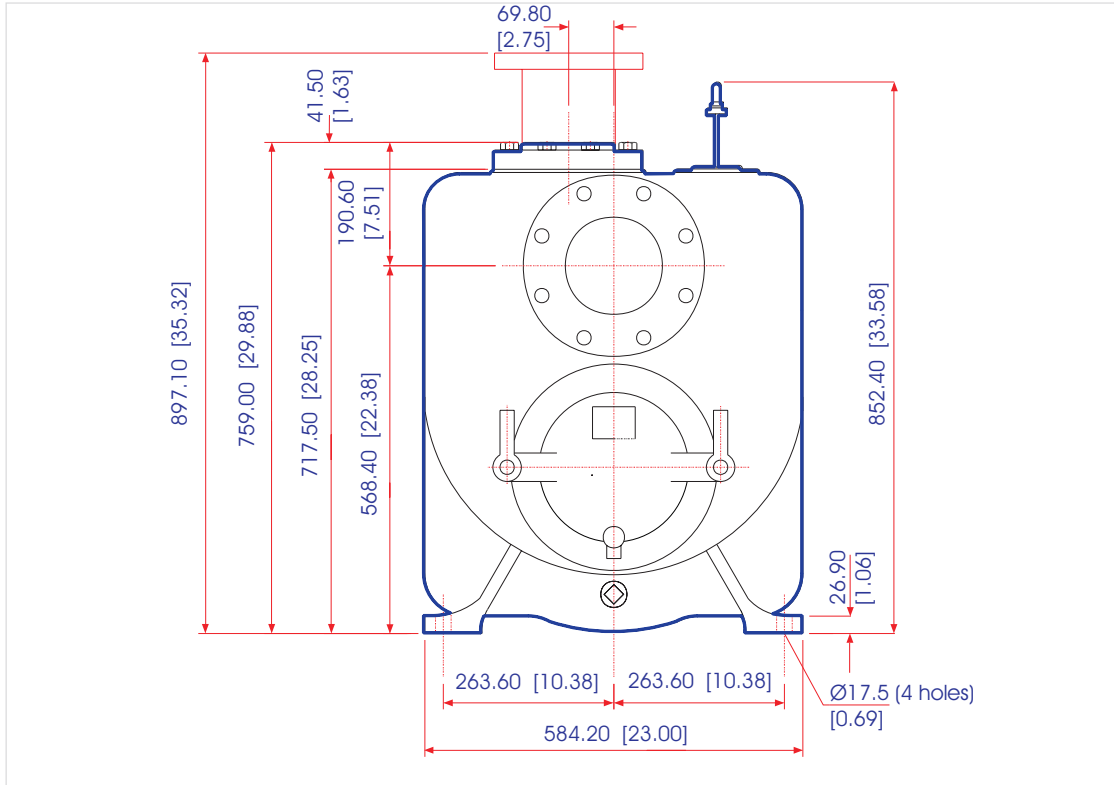

STATION LIFT

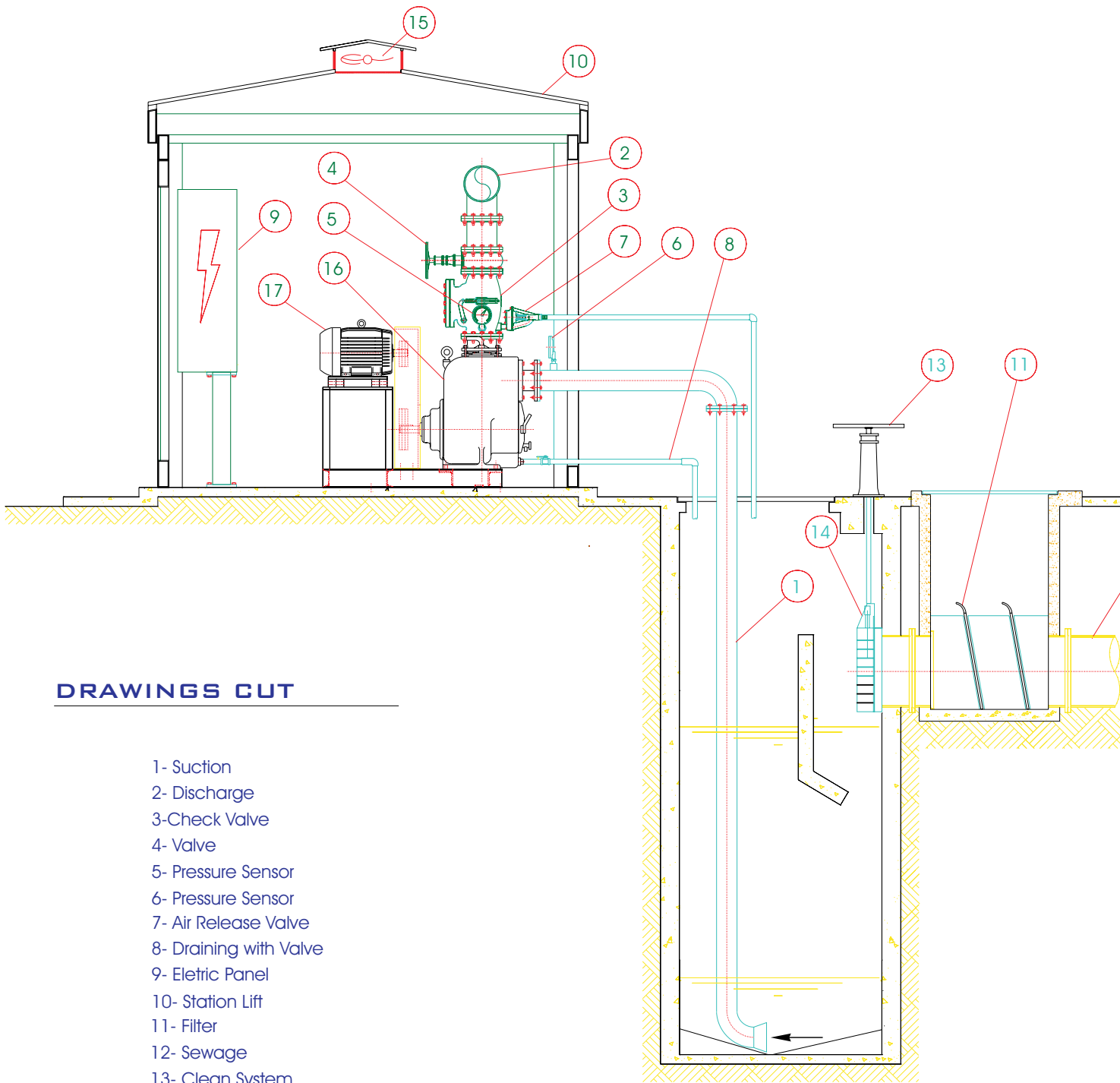

DRAWINGS CUT

- 1- Suction
- 2- Discharge
- 3- Check Valve
- 4- Valve
- 5- Pressure Sensor
- 6- Pressure Sensor
- 7- Air Release Valve
- 8- Draining with Valve
- 9- Electric Panel
- 10- Station Lift
- 11- Filter
- 12- Sewage
- 13- Clean System
- 14- Valve
- 15- Fan
- 16- Esco Pump (Series P or H)
- 17- Electric Motor